



- TRIAA -
VASANTAM
CITY CENTER

PREMIUM BUSINESS SPACES
— DHANORI —



Conceptual Image

THE NEW FACE OF **BUSINESS SPACES** IN DHANORI!

Triaa Vasantam City Center is designed with one goal in mind: To create an incredibly advantageous commercial address for flourishing businesses. Envisioned to take shape at the blooming locale of Dhanori, these state-of-the-art office spaces are sure to offer your business a leap of growth, with the latest infrastructure and ergonomic design meant to inspire productivity!



- TRIAA -
VASANTAM
CITY CENTER

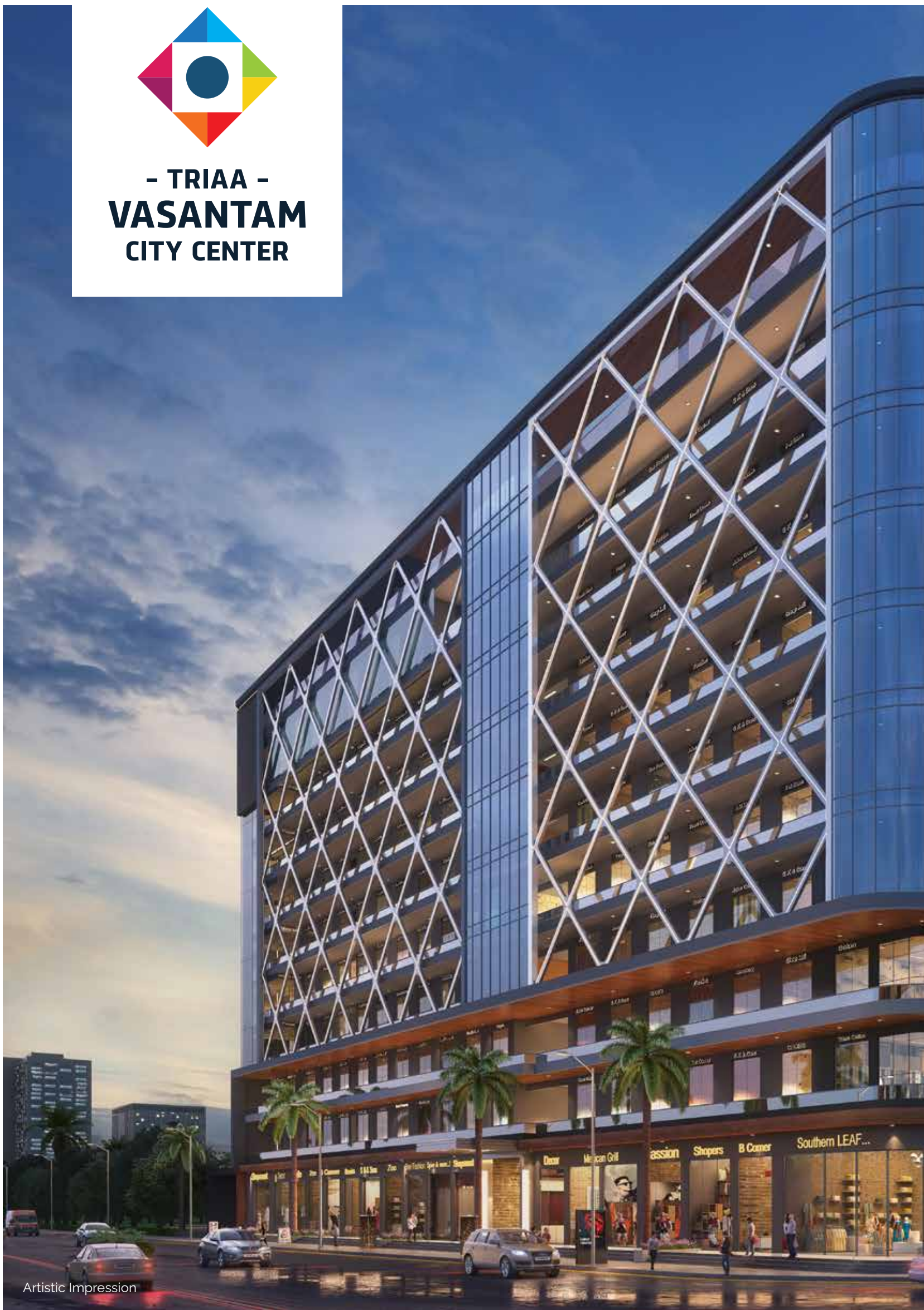



THE NEW FACE OF **RETAIL SPACES** IN DHANORI!

The key to retail success lies in an opportune location and a modern structure offering ample visibility. Triaa Vasantam City Center is soon to become one such retail destination that combines engaging shopping experience and incredible visibility in the bustling residential and commercial neighbourhood of Dhanori. The best mix of well-equipped retail spaces and superb connectivity here is bound to attract modern shoppers towards your brand.

IDEAL FOR



Showrooms



Luxury Brands



Supermarkets



Salons



Fashion Houses



Conceptual Image

HIGH ON **VISIBILITY**
HIGH ON **RETURNS**
IN DHANORI!







Conceptual Image

THE NEW FACE OF **OFFICE SPACES** IN DHANORI!

The incredible advantage here lies in its inclusivity. The design, layout, and spacing seamlessly incorporate offices for businesses with small or medium operations. Vasantam is an ambitious quest to create a high-tech platform for the thriving business community in this part of the town.

IDEAL FOR



Boutique Offices



Professional Consultants



Clinics



IT Companies



Training Centres



Banks/NBFCs



Artistic Impression

THE NEW FACE OF COMMERCE



SPECIFICATIONS

STRUCTURE, MASONRY WALLS, EXTERNAL FACE & PLASTER/PAINTS

- » RCC framed structure
- » Masonry walls in AAC blocks
- » Aluminium composite panels and glazing for elevation as per design
- » Gypsum finished internal walls

FLOORING & DADO

- » Vitrified tiles flooring inside offices
- » Vitrified tile flooring & dado inside common toilets
- » Vitrified tiles in common terrace area
- » Staircase - Vitrified tiles for treads, risers and skirting
- » Lift lobby & common passage - Combination of marble and vitrified tiles

LIFTS

- » Passenger lifts and service lift. Brand - Kone/Otis/Schindler/Johnson/Mitsubishi

COMMON TOILETS

- » Concealed pipes plumbing lines
Brand - Finolex/Prince/Supreme
- » External plumbing lines - White UPVC
Brand - Astral
- » CP fittings. Brand - Jaquar/Grohe/
Isenberg/Kohler
- » Sanitary ware. Brand - RAK/Hindware/
Jaquar/Kohler/TOTO

ELETRIFICATION & CABLING

- » Concealed copper wiring with modular switches in common areas & common toilet area. Brand for electrical switches - Legrand/Schneider/Anchor. Brand for electrical wiring - Polycab/Finolex R.R.Kabel/Havells/Greatwhite
- » Electric supply of appropriate load from transformer up to DB at every floor/unit

DOORS

- » Laminated flush doors for offices
- » Laminated flush doors for common toilets

FALSE CEILING AT COMMON PASSAGE

- » False ceiling at common passage with modular gypsum board. Brand - Armstrong/AMF/Gyproc/Knauf/Danoline

PAINTING

- » All internal walls inside offices - Oil Bound Distemper. Brand - Dulux-ICI/Asian/Berger/Nerolac
- » Passage area - Acrylic paint



Conceptual Image



Artistic Impression

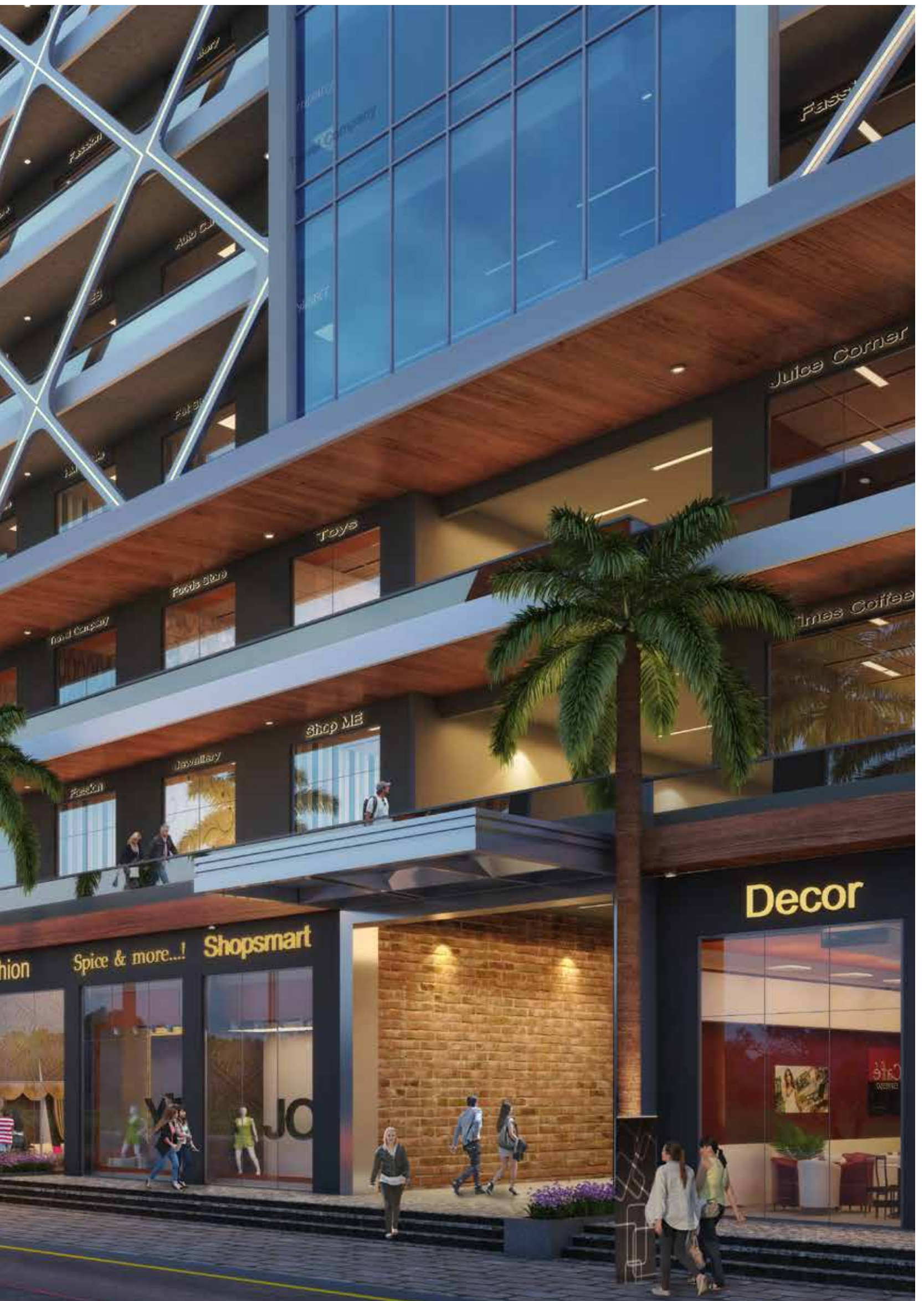

Fabrics

Fabrics

Auto Care

Auto Care

Juice Corner

Toys

Food Store

Times Coffee

Food Company

Shop ME

Jewellery

Fashion

Decor

Spice & more...! Shopsmart

hion

JO



Conceptual Image

PROJECT OVERVIEW



Generator back-up for shops, offices & common areas



LED fixtures for common areas



Internal tremix/concrete/pavers for driveways



STP as per statutory requirements



Ample car parking



Rain water harvesting



OWC

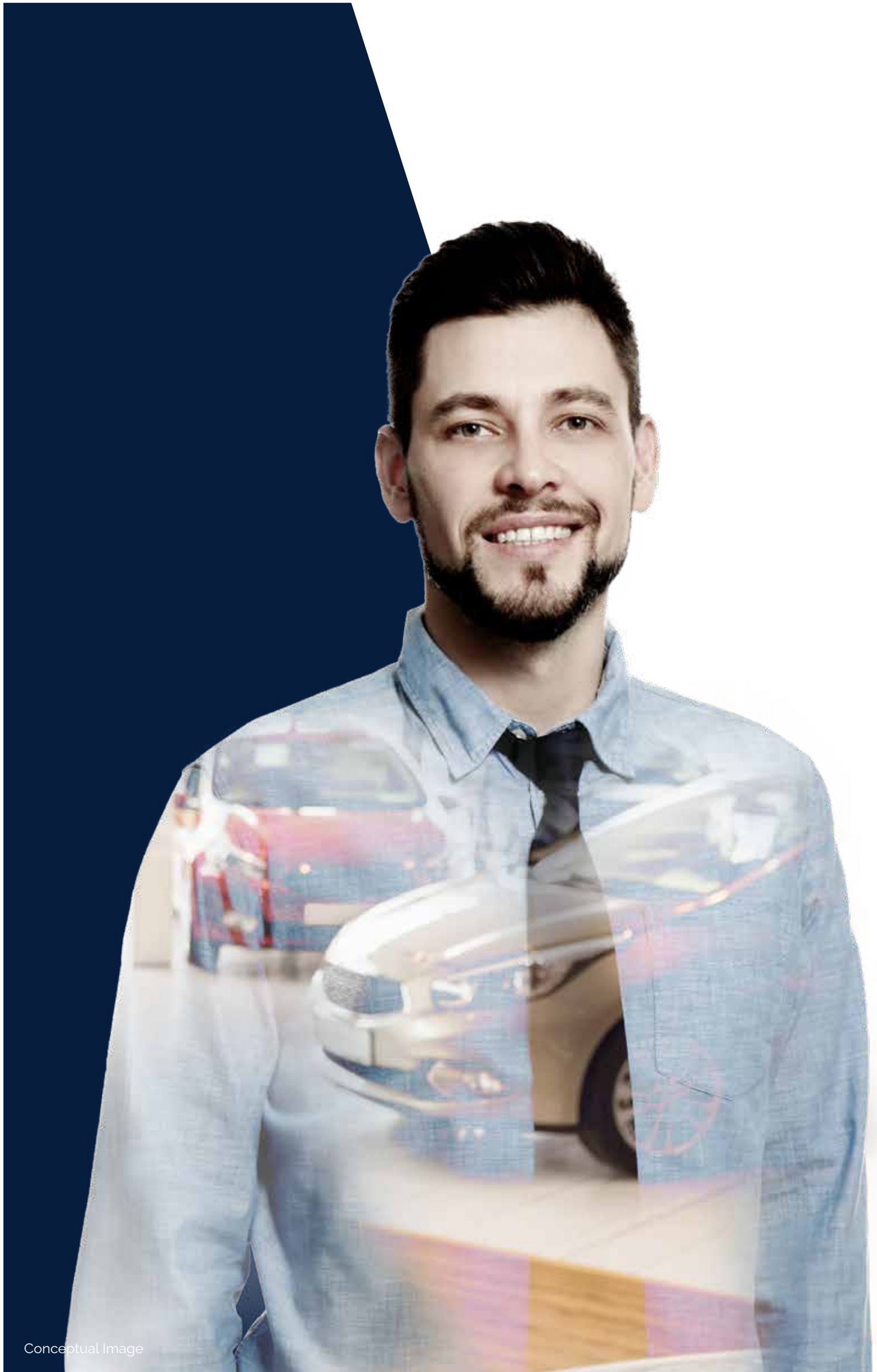

Conceptual Image

THE NEW FACE OF **CONNECTIVITY** IN DHANORI!

Surrounded by myriad opportunities, Dhanori is an ideal spot for your business. Barely 15 minutes away from Pune International Airport, the location enjoys incredible connectivity to Viman Nagar, Lohegaon, Kalyani Nagar, Vishrantwadi, Camp & Koregaon Park. Brimming with health care & education facilities and commercial & shopping complexes, Dhanori is proving to be one of the most strategic addresses in Pune for commercial investment.

LOCATION MAP



- TRIAA -
VASANTAM
CITY CENTER



KEY DISTANCES

- » Pheonix Market City – 4.5 km
- » Commerzone IT Park – 4.0 km
- » Pune International Airport – 2.2 km
- » Poonawalla Business Bay – 5.0 km
- » City Hospital – 100 m
- » Pune Railway Station – 8.0 km
- » Vishrantwadi – 3.5 km
- » EON IT Park – 7.0 km
- » Viman Nagar – 3.0 km
- » Kalyani Nagar – 6.0 km
- » DY Patil College – 3.0 km



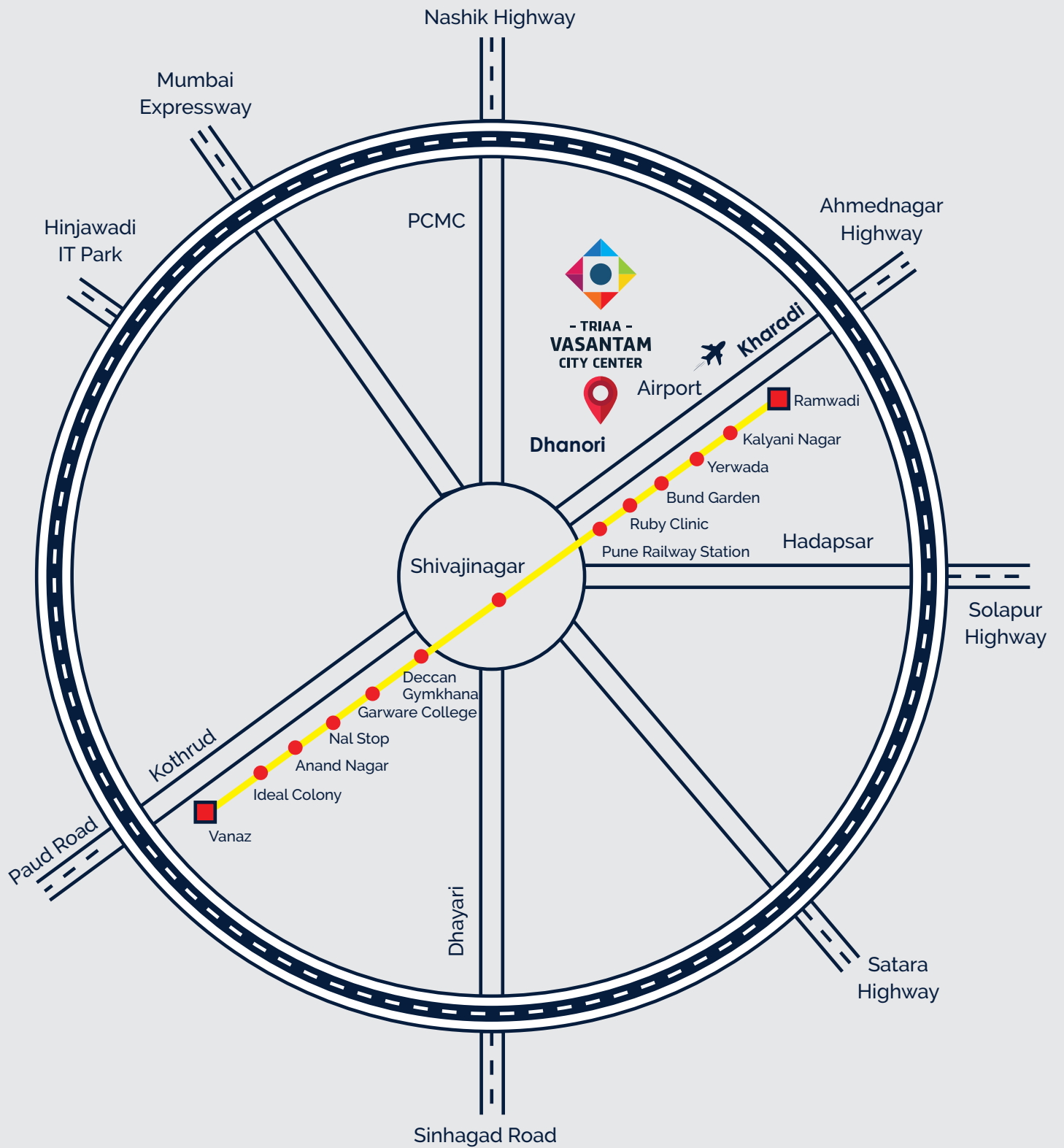

-  Pune Metro
-  Pune Ring Road Metro
-  14 Lane Ring Road



Founded by **Mr. Shyam Goel**, a leader in the field of development and construction for over 20 years. The group has conceived, designed and executed several prestigious commercial and residential projects in and around Pune & caters to niche markets. The company believes in providing customer delight by adopting customer centric value for money philosophy. At **Triaa**, corporate governance and ethical policies are implemented by our thoroughly professional and experienced team. As a customer, you can be rest assured that you have made the right choice by deciding to be among the proud owners at our projects.

OUR MILESTONES



COMPLETED PROJECTS

- » **Triaa Hillome**, Lohegaon
- » **Castle Royale**, Lohegaon
- » **Augustaa**, Kharadi
- » **Punyavaastu**, Alandi
- » **Triaa Princetown**, Shikrapur
- » **Goodwill 24**, Lohegaon
- » **Saachee Era**, Moshi
- » **Polaris**, Hadapsar
- » **Ekaika**, Kharadi

And many more...

ONGOING



SHUBH GATEWAY, VIMAN NAGAR



K CITY, KESHAV NAGAR



GOODWILL BREEZA, DHANORI



ELYSIA, KESHAV NAGAR



KOSMIC COURTYARD, WAGHOLI



CREDITS

Architect:
Cubix Architects

Liasoning Architect:
**Sandeep Hardikar
& Associates**

RCC Consultant:
Structure Vizion

Landscape Designer:
Mahesh Chinchalkar

3D Visualisation:
Square One

Legal Advisor:
Adv. Ramgopal Bansal

Site Address

Corporate Address

Office No. 401/A, City Bay, City Point Tower, Dhole Patil Road, Pune - 411 001

83904 50399 | 83904 50400 | www.triaahousing.in

A Project by



TRIAA



KOSMIC BUILDERS



MAHARERA NO.: P52100032750 | <https://maharera.mahaonline.gov.in>

Disclaimer: This perspective image may not be to scale or may not represent actual facade/elevation. The details of windows, paints, elevation features, landscaping, ground development, trees or any other details in this perspective are an artist's impression and could be different to actual. The viewer affirms that he/she has not taken his/her decision of purchase/booking by viewing this perspective. This brochure is not a legal offering. The developers reserve absolute rights to change/cancel any plans, layouts, no. of floors and/or specifications at their discretion. Images are for representational purposes only.