



# Silver Gardenia

- A PROJECT BY SILVER GROUP -

## Credits

Architects - IP Associates  
(Mr. Aditya Pungavkar & Mr. Satyajeeet Inamdar)

RCC Consultants  
Mr. Rahul Kapse



 **Site Address:** Gat No.: 153, Borhadewadi, Moshi - 412 105

 silvergardeniamoshi@gmail.com | sales1717@silvergrouprealty.com

 www.silvergrouprealty.com

 **888 888 9379 | 888 888 6421 | 909090 7271 | 9168 171717**

Disclaimer: This brochure purely conceptual and not a legal offering. The pictures/images/elevations are for representational purposes only and are subject to change.

MAHAREERA NO.: P52100034553 | <https://maharera.mahaonline.gov.in>



# Silver Gardenia

- A PROJECT BY SILVER GROUP -

A world in itself, Gardenia is a living paradise soon to be home to a vibrant community right in the heart of Moshi. The project has been designed keeping in mind a peaceful and harmonious experience for all its residents. The project is spread around 4.83 acres with much free space for the wind to flow freely, for your kid's imagination to run wild and for everyone to enjoy wide views of the sky! Gardenia offers spacious 2, 2.5, 3 BHK flats & 4.5 BHK Duplex homes keeping in mind the buyer needs! The project is surrounded with lush 2.5 acres of PCMC garden to keep you fresh all the time! 20 story buildings will surely bring beautiful scenery in your home and you can experience throughout a day & night!

**Come home to gardenia & explore high chanting views with gardenia life!**

PASTING

# Reimagine *Luxury*

At Silver Gardenia, you can surely reimagine luxury in every look and nook of project. Right from location to specifications used in internal flats will blow you away! Well planned amenity space includes 2 luxurious club houses, swimming pool, box cricket ground, podium parking, and much more! Here, luxury is what you feel, what you see and you have the desire to achieve it always in your life! So visit and be a part of it.

**Come home and experience a gardenia life!**

2, 2.5, 3 BHK Flats & 4.5 BHK Duplex Homes





A

B

C

D

F

E

PCMC  
GARDEN

Reimagine  
Premium  
*Living!*

# Reimagine Connectivity!

Silver Gardenia, located in central moshi just few kms away from rapidly developing economic zone. Well known educational institutes, MIDC's, retail markets are in close proximity. A well developed residential community offers good neighbors, smarty planned public transport facilities, hassle free commute, etc. Central Moshi offers unique advantages.

## Silver Gardenia offers supreme connectivity to

- International Convention Center
- Pune -Nashik Highway
- Upcoming COEP College
- Reputed Schools
- Upcoming District Court
- Retail Market
- Talawade IT Park
- Hospitals etc.
- Chakan, Bhosari, Chinhwad MIDC's
- Divine places like Dehu & Alandi.



**Silver  
Gardenia**  
- A PROJECT BY SILVER GROUP -





Reimagine  
Scenic *Life*

2, 2.5, 3 BHK Flats & 4.5 BHK Duplex Homes



*A luxury swimming pool to keep athlete alive within you!*



  
**Silver  
Gardenia**  
- A PROJECT BY SILVER GROUP -





pasting part



  
**Silver  
Gardenia**  
- A PROJECT BY SILVER GROUP -



*Luxury Club House*





*Box Cricket to keep a  
player alive within you.*

# COMMON AREAS & AMENITIES

1. Club House
2. Pool Deck
3. Swimming Pool / Kid's Pool
4. Temple
5. Seating Deck
6. Stage
7. Pathway
8. Kid's Play Zone
9. Gymnasium
10. Indoor Games Room
11. Senior Citizen's Sit-outs
12. Multi Play Court
13. Multipurpose Lawn
14. Party Hall Multipurpose
15. Meditation Yoga Space
16. Toilet / Shower / Changing Room

# SPECIFICATIONS

1. Premium Quality Doors
2. Granite Kitchen Platform
3. SS Kitchen Sink
4. Premium Quality Sanitary Fittings
5. Premium Quality CP Fittings
6. Premium Quality Plumbing work
7. Premium Quality Electrification
8. Premium Quality Switches
9. Electrical Points with MCB
10. External Sand Faced / Sponge
11. Finished Plaster
12. Internal Gypsum Coating
13. Earthquake Resistance Structure
14. Premium quality Tiles upto Lintel Level



**2 BHK**

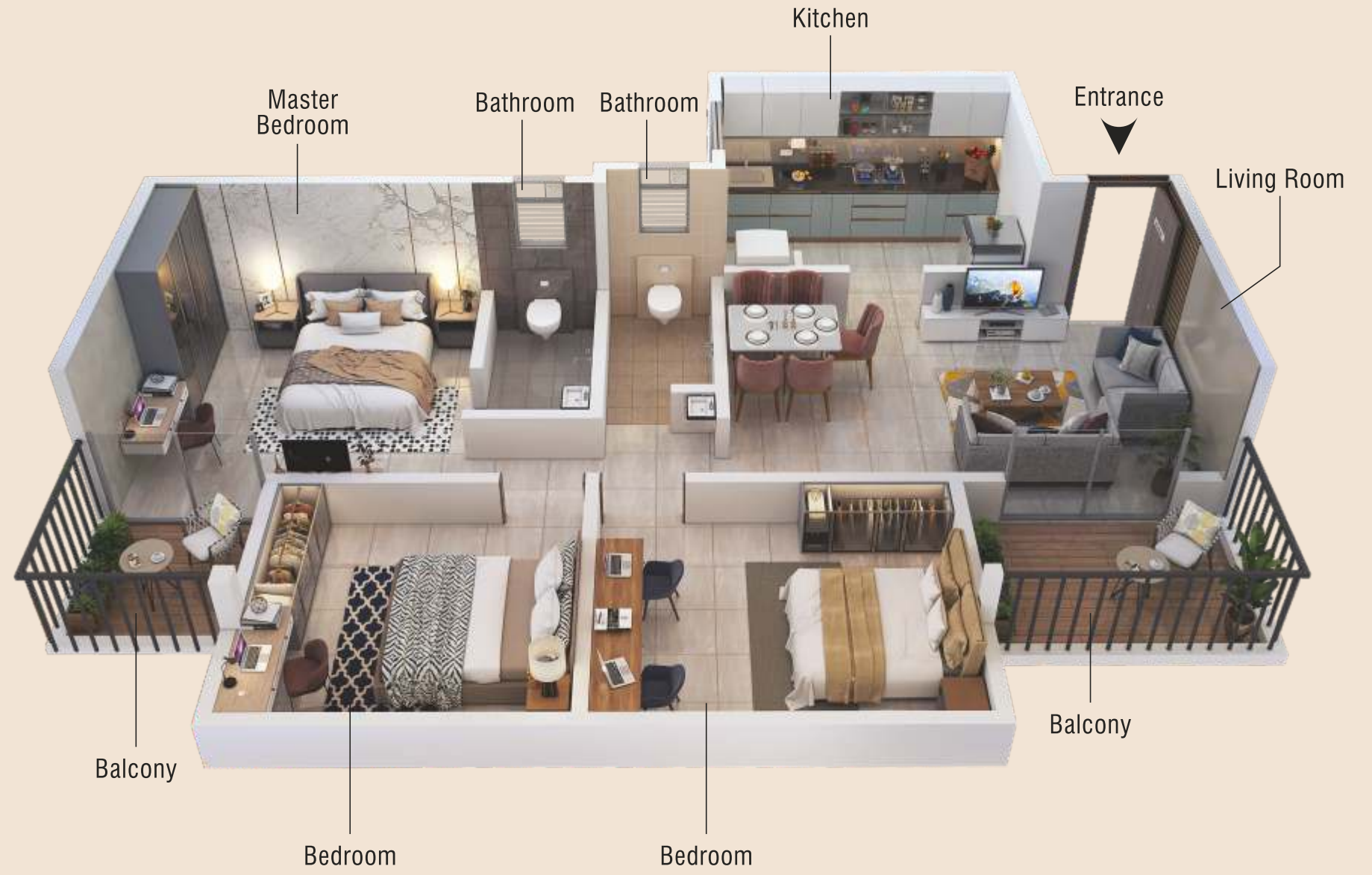

**2.5 BHK**

# 3 BHK

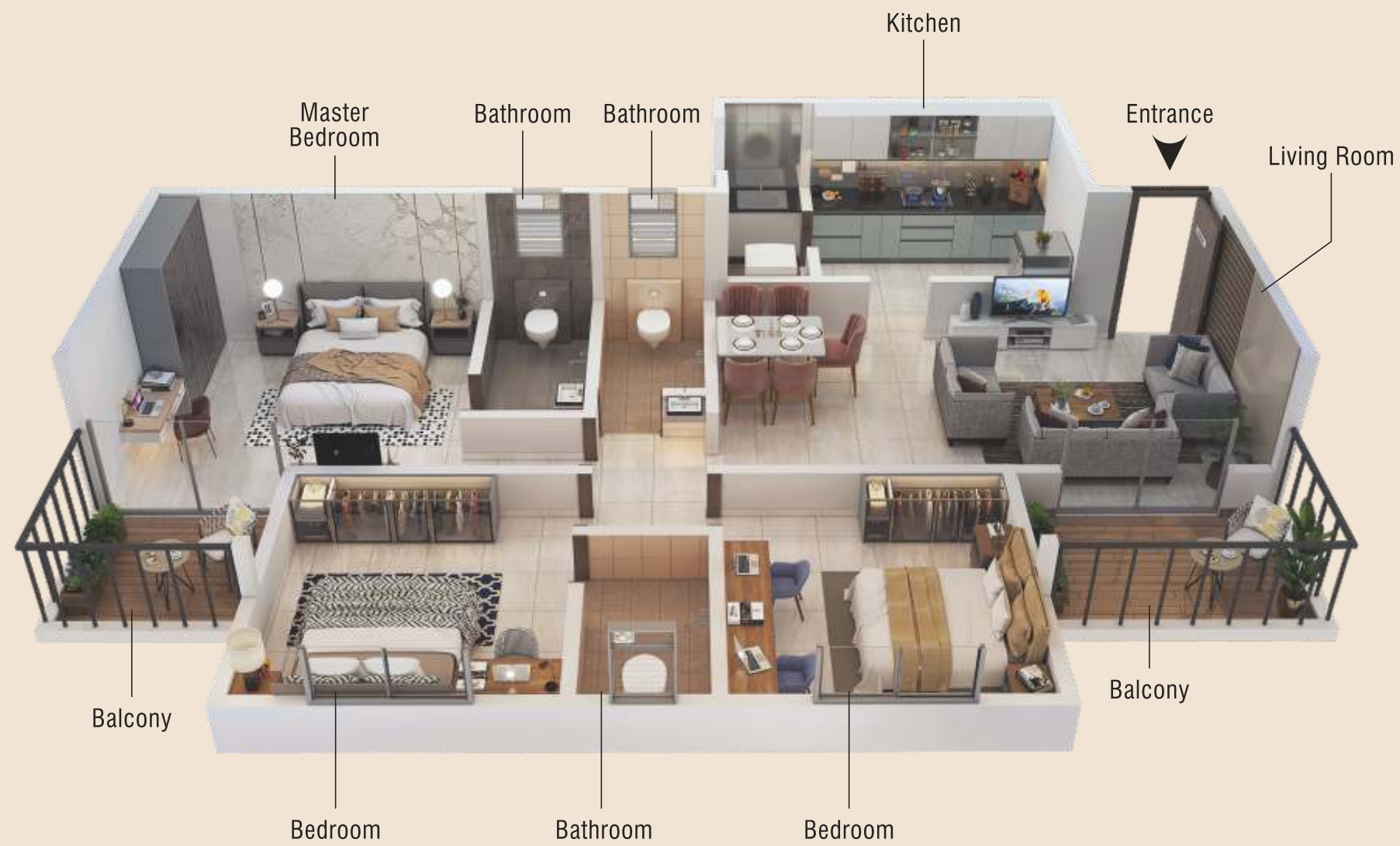

# 4.5 BHK DUPLEX



# LOWER FLOOR



# UPPER FLOOR



### MALLS

|                           |         |
|---------------------------|---------|
| D- MART .....             | 2 MINS  |
| SILVERIAN MALL .....      | 2 MINS  |
| SILVER CENTRAL MALL ..... | 5 MINS  |
| PRIVIA MALL .....         | 10 MINS |
| JAI GANESH SAMRAJYA ..... | 10 MINS |
| CITY ONE MALL .....       | 15 MINS |
| SPINE CITY MALL .....     | 10 MINS |

### HOSPITALS

|                                      |         |
|--------------------------------------|---------|
| MASKE HOSPITAL .....                 | 5 MINS  |
| SAINATH HOSPITAL .....               | 10 MINS |
| LOTUS MULTISPECIALITY HOSPITAL ..... | 10 MINS |
| DNYANSAGAR MULTISPECIALITY .....     | 10 MINS |
| ACCORD SDH HOSPITAL .....            | 10 MINS |
| LOKMANYA HOSPITAL .....              | 15 MINS |
| MOSHI HOSPITAL .....                 | 2 MIN   |
| STAR SPECIALITY HOSPITAL .....       | 4 MIN   |
| SANT DHYANESHWAR HOSPITAL .....      | 10 MIN  |
| ASTHA HOSPITAL.....                  | 10 MIN  |

### BANKS

|                            |         |
|----------------------------|---------|
| AXIS BANK .....            | 4 MINS  |
| ICICI BANK .....           | 10 MINS |
| BANK OF INDIA .....        | 10 MINS |
| SBI BANK .....             | 10 MINS |
| HDFC BANK .....            | 10 MINS |
| JANATA SAHAKARI BANK ..... | 10 MINS |

### SCHOOLS

|  |         |
|--|---------|
| PHOENIX PRE SCHOOL .....               | 3 MINS  |
| CITY PRIDE SCHOOL .....                | 5 MINS  |
| SRI SRI RAVISHANKAR VIDYA MANDIR ..... | 5 MINS  |
| PRIYADARSHANI HIGH SCHOOL .....        | 5 MINS  |
| KIDZEE SCHOOL .....                    | 5 MINS  |
| GLOBAL TALENT SCHOOL .....             | 10 MINS |

### KEY PLACES

|                   |         |
|-------------------|---------|
| MOSHI .....       | 5 MINS  |
| PRADHIKARAN ..... | 5 MINS  |
| KUDALWADI .....   | 5 MINS  |
| PCMC .....        | 20 MINS |
| CHIKHALI .....    | 5 MINS  |
| TATA MOTORS ..... | 10 MINS |
| ALANDI .....      | 15 MINS |
| BHOSARI .....     | 10 MINS |

